

## Self Clinch Floating Nut Installation Guide

1

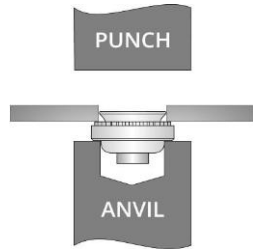

Punch Or Drill Hole To Specified  
Seat Fastener Squarely In The Hole

2

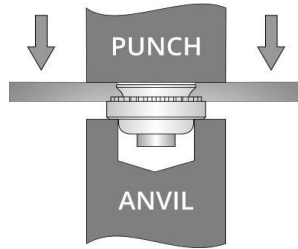

Squeeze Fastener Into Panel  
Until Knurling Under The Head  
Is No Longer Visible

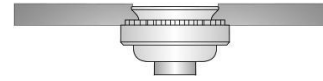

Anvil

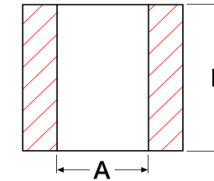

Anvil Dimensions		
Thread Codes	A	L
	0.12	Min.
M3	7.5	6.5
M4	9.41	6.8
M5	10.42	8.5
M6	13.09	9.0

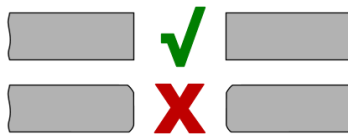

Do not remove any extra material or chamfer the hole as this could result in improper installation or reduced performance

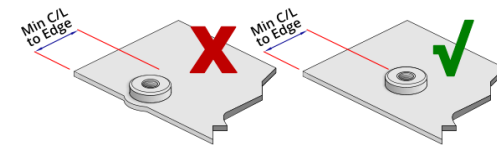

Ensure That Attention Is Paid To The Minimum Hole Centreline To Edge Dimension For Each Fastener. Installing Too Close To An Edge Or Bend Could Result In Improper Installation Or Reduced Performance. Minimum Centreline To Edge Dimensions Shows Each Fastener And Applies To One Edge Only. If This Distance Is Applied On Multiple Sides There Will Be Significant Panel Distortion Unless The Panel Edges Are Supported During Installation.